

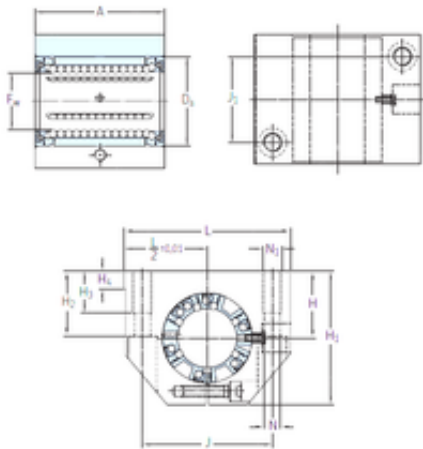

BEARING SUDAMERICANA, S.A.

SKF LUNE 50 linear bearings



Bearing No. LUNE 50

Bore Diameter	50 mm
Fw	50 mm
H4	11 mm
H3	35 mm
Da	75 mm
A	100 mm
H	50 mm
H1	105 mm
H2	49 mm
J	108 mm
L	132 mm
N	13,5 mm
J1	50 mm
Thread (N1)	M16
Weight	2,47 Kg
Basic dynamic load rating (C)	11,2 kN

LUNE 50 Bearing 2D drawings and 3D CAD models